

Elementary School #42

Schematic Design Report

Scott Washington

Director, School Construction

July 9, 2015

Project Overview

- Fourth use of the prototype elementary school plans based on the 2003 Elementary School Educational Specifications.
- 788 seat capacity prototype used to address the enrollment growth of the Route 1 corridor.
- Emphasis is placed on bringing the plans into line with our concerns and goals of energy efficiency.

Project Overview (cont.)

- Plan updated to address the changes between 2003 and 2010 specifications.
- LEED 'Gold' certificate project.
- Recommended layout modifications include addition of kindergarten room, enclosure of ELRs, development of spaces to address flexibility.
- Another unique opportunity to work collaboratively with the developer of the surrounding Oxford Square Community

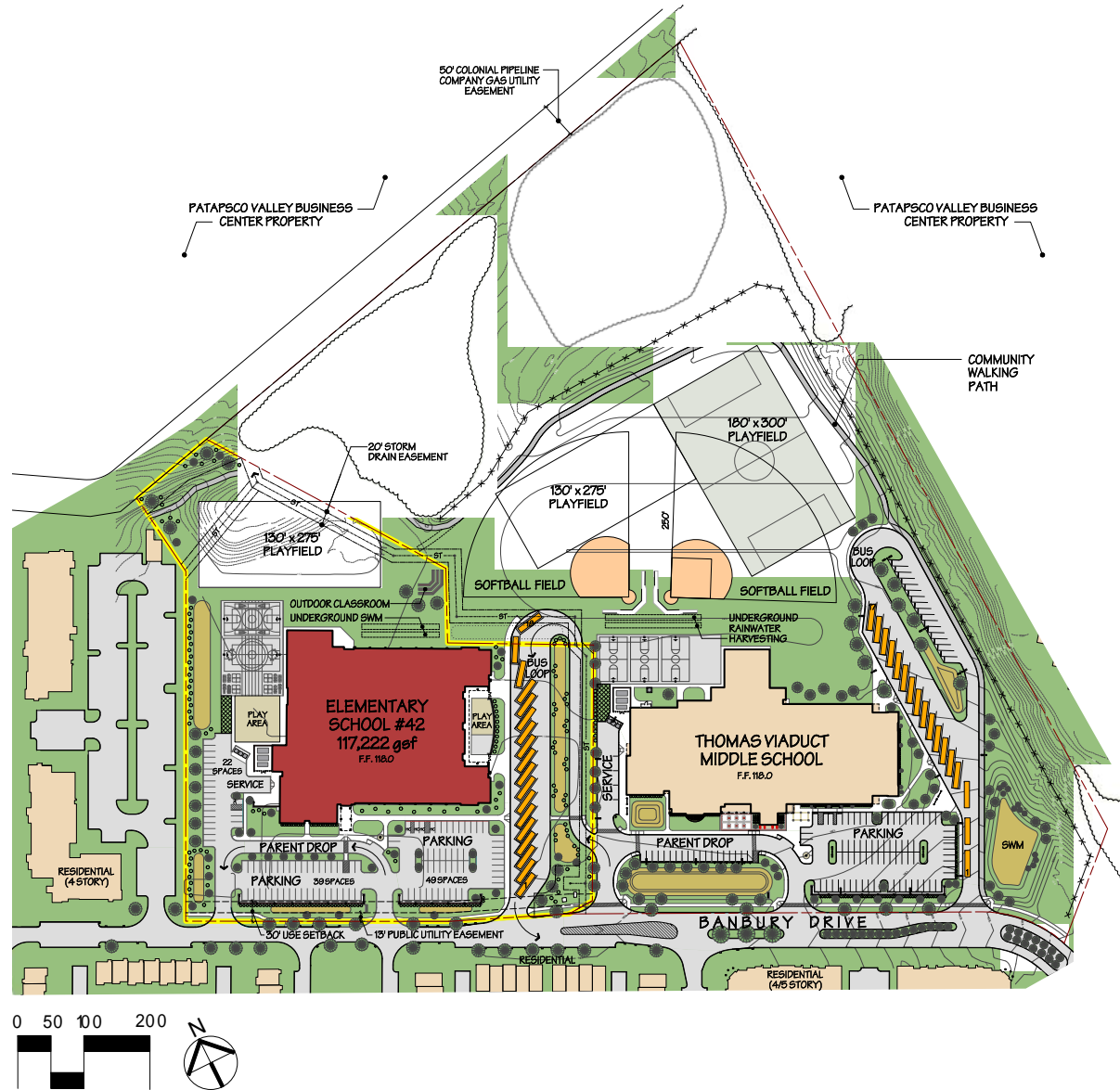

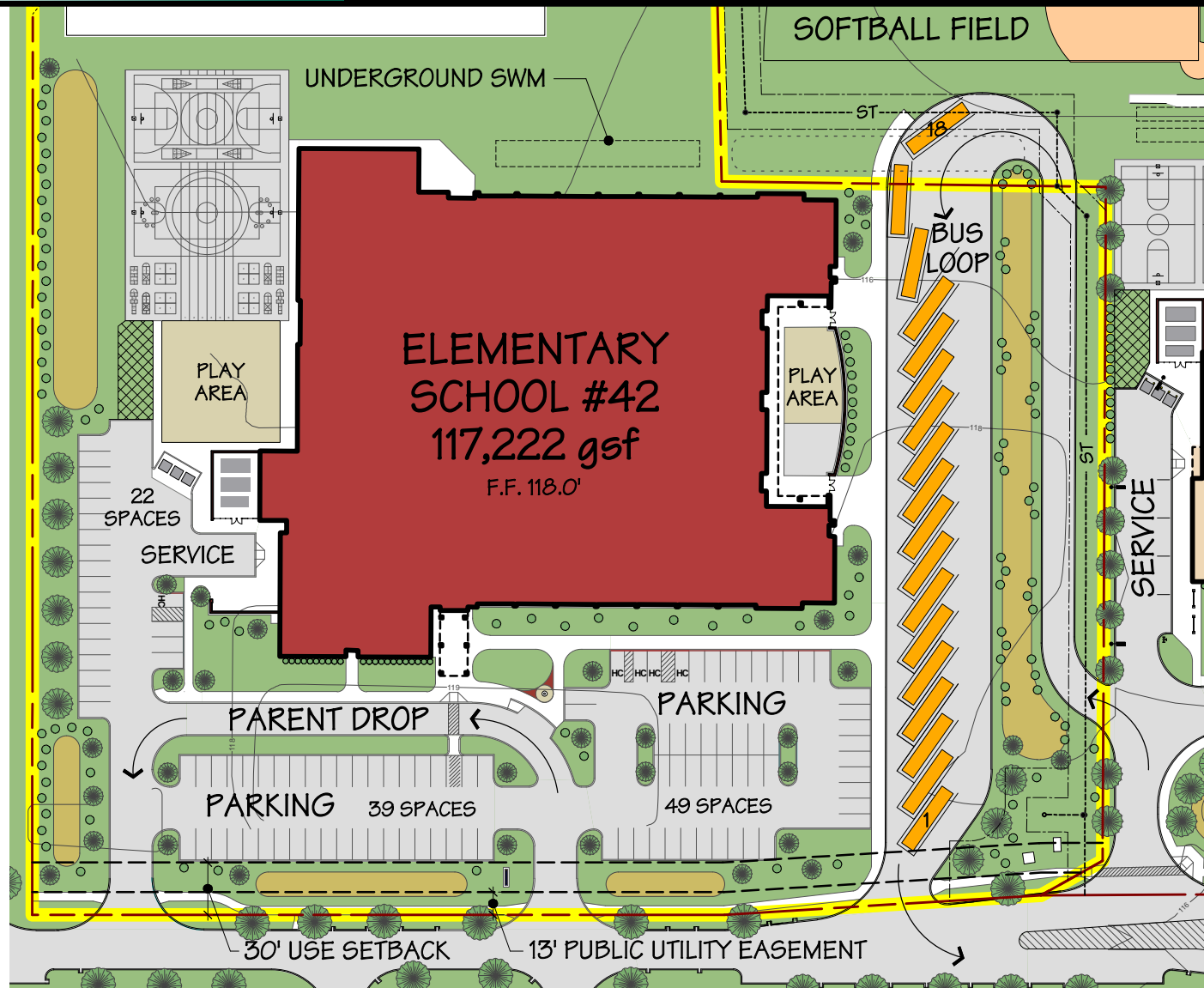

Enlarged Site Plan

LEGEND

- Kindergarten / Early Childhood
- Grades 1-5
- Special Education
- Central Support Spaces
- Administrative Spaces
- Building Services
- Rec. and Parks

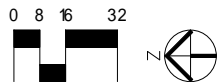

First Floor Plan

ES#42 Schematic Design

LEGEND

- Kindergarten / Early Childhood
- Grades 1-5
- Special Education
- Central Support Spaces
- Administrative Spaces
- Building Services
- Rec. and Parks

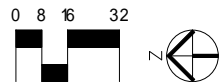
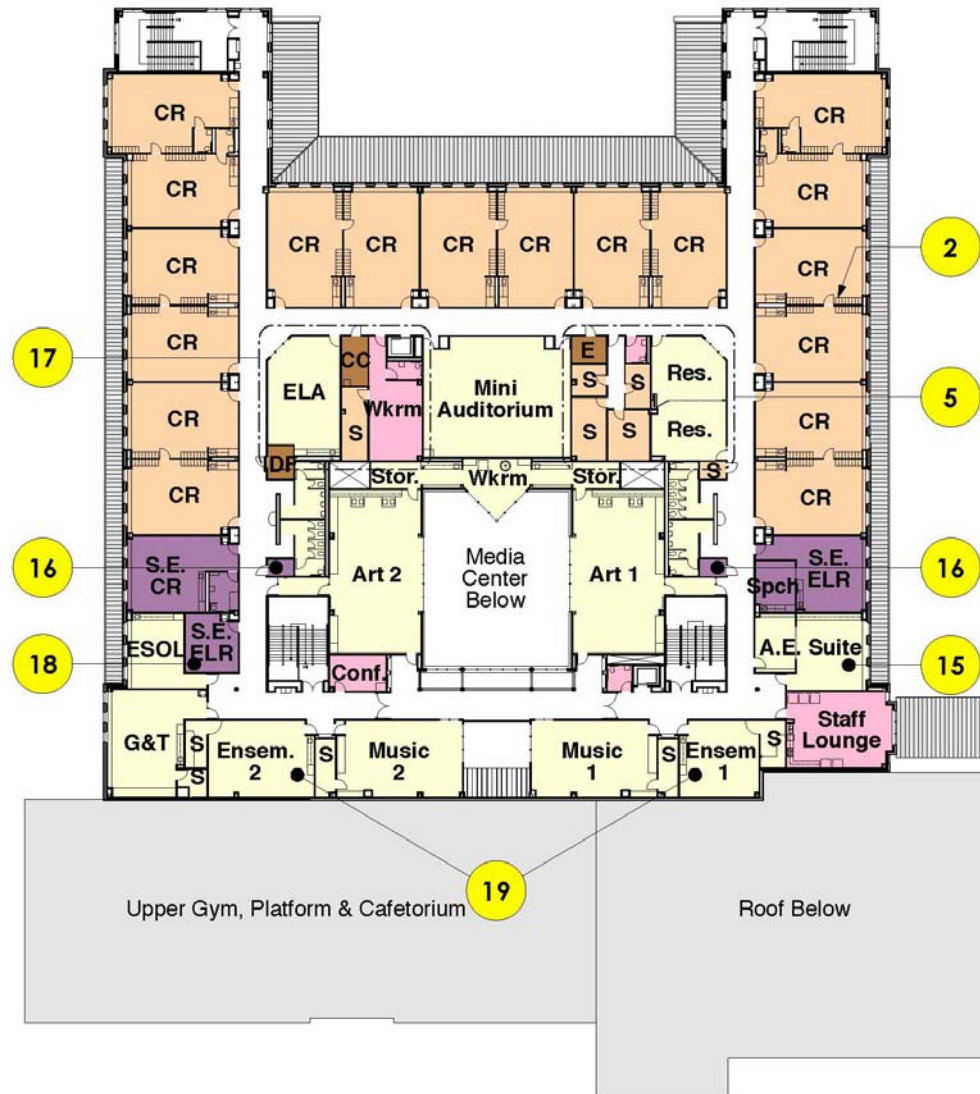

Second Floor Plan

ES#42 Schematic Design



View of Thomas Viaduct Middle School and Elementary School from Banbury Drive

Summary

- Schedule
 - Schematic Design (SD) report July 2015
 - Design Development (DD) report October 2015
 - Construction Documents (CD) report April 2016
 - Construction starts September 2016
 - Completion August 2018
- Request approval to move into DD phase