

New Elementary School #42

Design Development Report

Scott Washington

Director, School Construction

October 22, 2015

Project Update

- Reconfiguration of administrative suite to provide a larger workroom and separate supply storage
- Reconfiguration of the health suite to increase cot visibility from the nurse's office and assistant's desk
- Increased the size of all instructional areas within each of the kindergarten classrooms
- Revised stair layout at both end stairs to allow for more natural daylight in these circulation spaces

Project Update (cont.)

- Site plan has been revised to improve the pedestrian connections to the surrounding community
- An outdoor classroom has been developed for use as a teaching space as well as located for use by the community
- Exterior elevations have been revised from the prototype to coordinate with the surrounding architecture

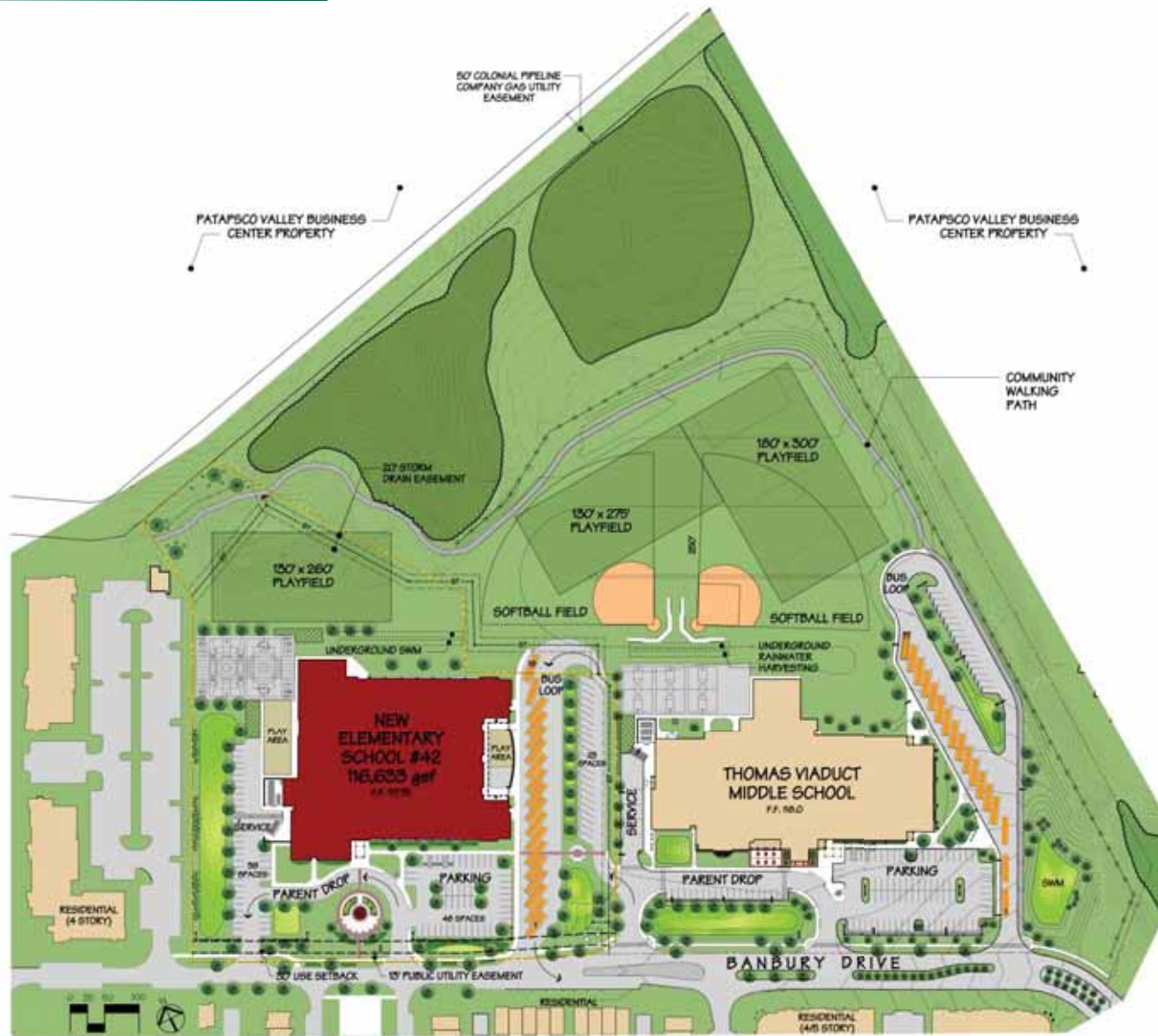

Site Plan

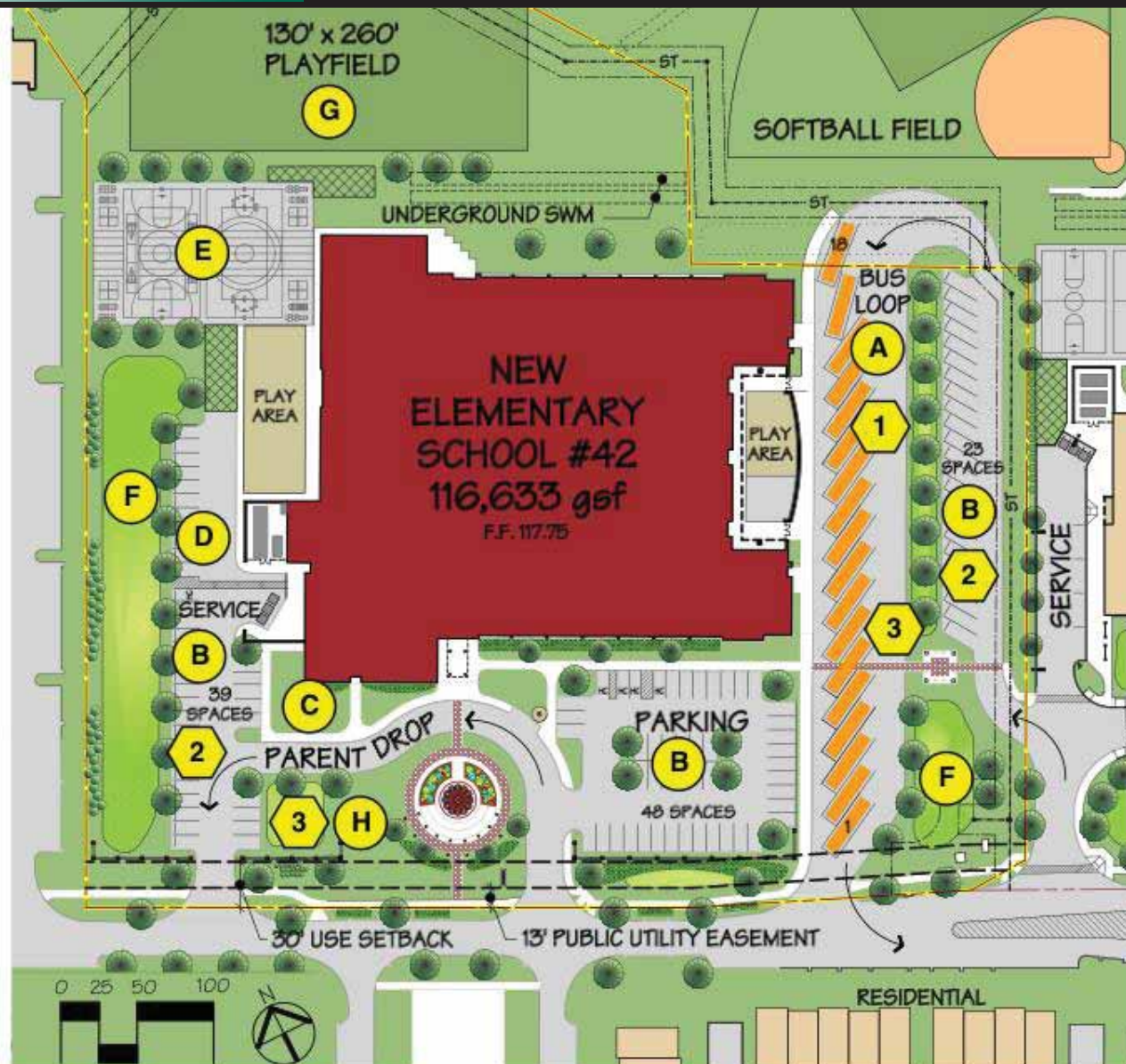

Enlarged
Site Plan

LEGEND

- Kindergarten / Early Childhood
- Grades 1-5
- Special Education
- Central Support Spaces
- Administrative Spaces
- Building Services
- Rec. and Parks



Design
Development
First Floor Plan

LEGEND

- Kindergarten / Early Childhood
- Grades 1-5
- Special Education
- Central Support Spaces
- Administrative Spaces
- Building Services
- Rec. and Parks

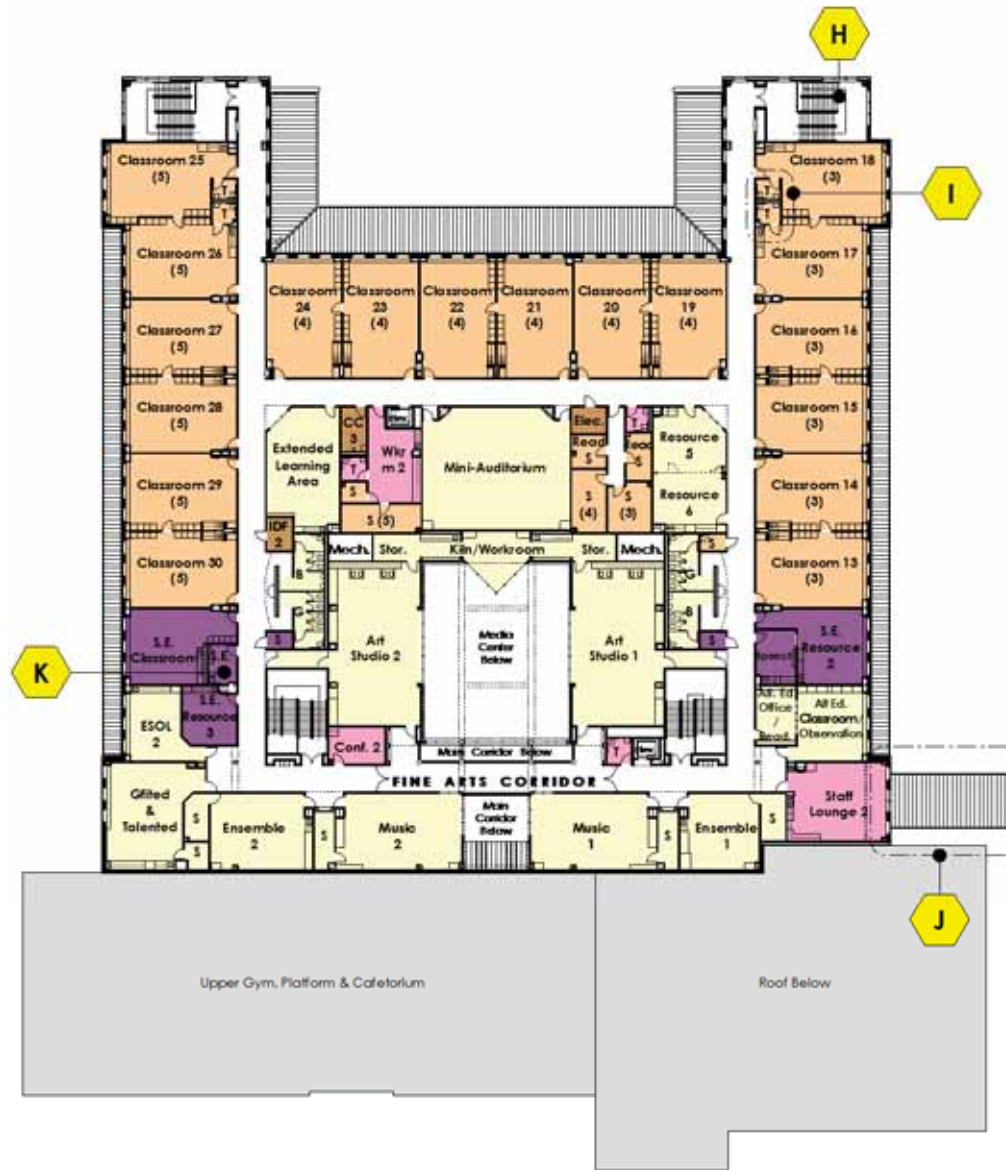

Design
Development
Second Floor Plan

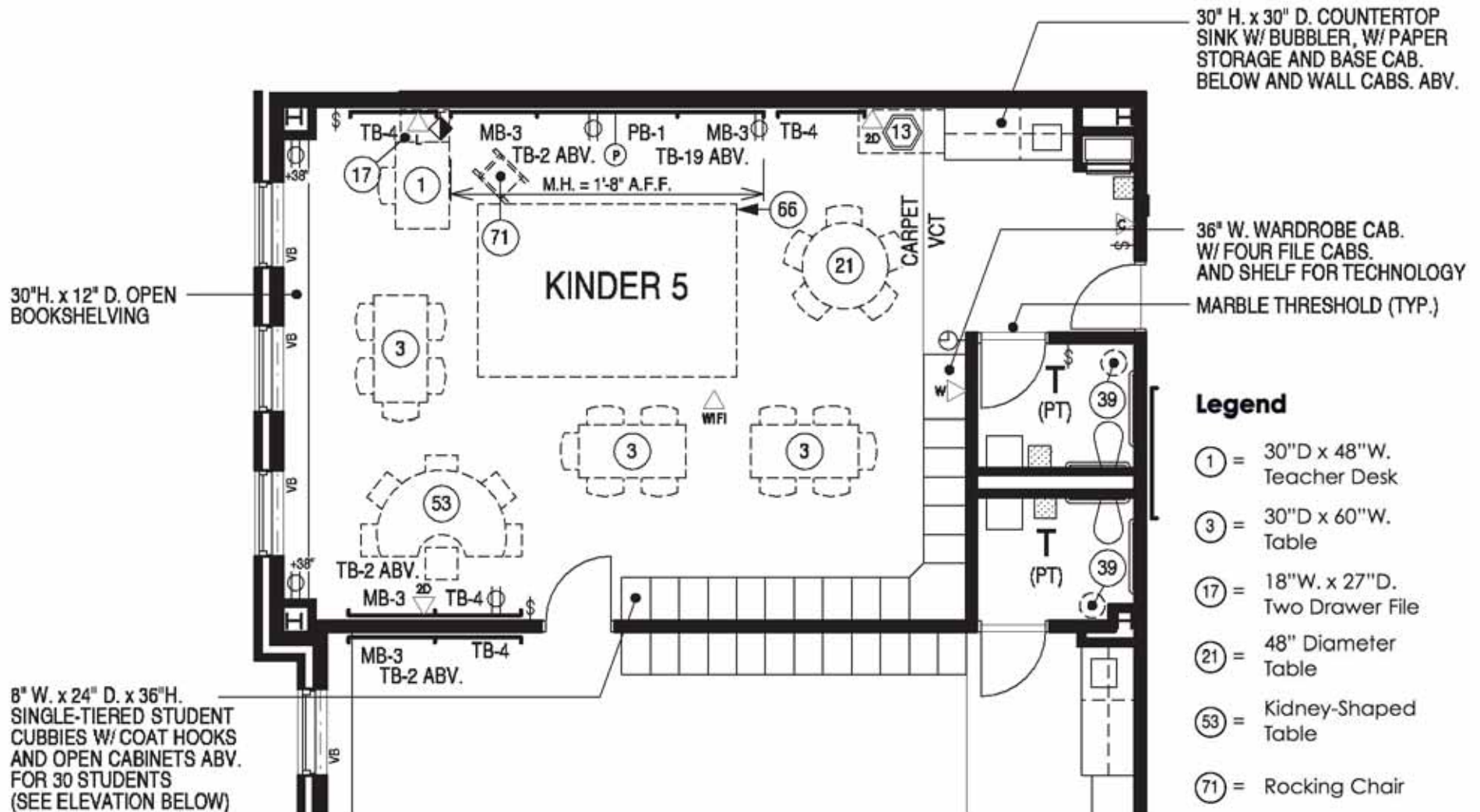

New Elementary School #42



Front Elevation

Total Project Budget

Base Construction Estimate	\$33,252,535
Architect/Engineering Fee	\$2,474,585
Construction Management Fee	\$2,350,000
Related Costs	\$1,666,000
Project Contingency	\$1,666,000
Equipment and Technology	\$2,333,520
Alternate #1: Outdoor Classroom at Main Entrance	\$159,485
Alternate #2: Instructional Gazebo at Bus Loop	<u>\$49,484</u>
Project Total Budget	\$43,951,609

Funding Projections	
FY16	\$2,807,000
FY17	\$16,526,000
FY18	\$20,658,000
FY19	<u>\$4,132,000</u>
Total Funding Projections	\$44,123,000

Summary

- Schedule
 - Construction Documents (CD) report April 2016
 - Receive bids July 2016
 - Construction starts September 2016
 - Completion August 2018
- Request approval to move into CD phase