

Deep Run Elementary School Design Development Report

Bruce Gist

Director, School Construction

October 22, 2013

Project Updates

- Enlarged classrooms in teaching pods
- Revised layout of staff lounge and student restrooms
- Renovated existing music classroom and mechanical space into a full music suite
- Provided additional classroom pod storage and custodial closet in the classroom addition

Project Updates (cont.)

- Added ADA accessible egress stair and ramp at classroom addition
- Added storm water management facility per code review
- Widened Old Waterloo Road and added sidewalk to provide student drop-off lane
- Relocated ESOL rooms, Title I Offices, Reading Resource & Recovery, and Student Support offices for better adjacency



EXISTING SITE PLAN



PROPOSED SITE PLAN

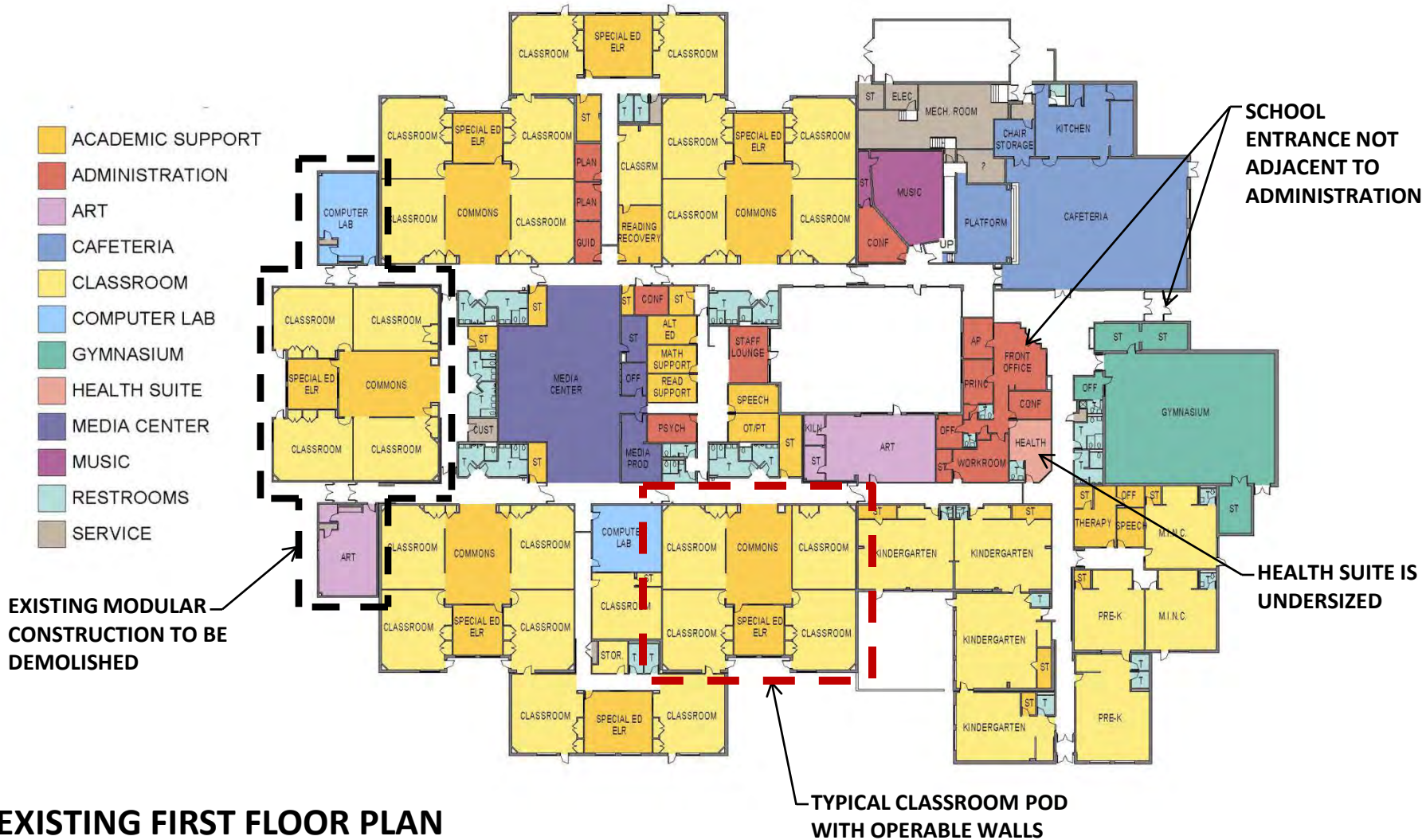

**NEW STOREFRONT
WITH DOORS ADDED
TO MEDIA CENTER TO
SEPERATE FROM
CORRIDOR**

RENOVATED MUSIC SUITE

**ADMINISTRATION
ADDITION:**
- ADMIN SUITE
- SECURE SCHOOL
ENTRANCE

- ACADEMIC SUPPORT
- ADMINISTRATION
- ART
- CAFETERIA
- CLASSROOM
- COMPUTER LAB
- GYMNASIUM
- HEALTH SUITE
- MEDIA CENTER
- MUSIC
- RESTROOMS
- SERVICE

CLASSROOM ADDITION:
- 6 REBUILT CLASSROOMS
- MECHANICAL ROOM
- ELECTRICAL ROOM
- STAFF TOILETS



**RENOVATED
ADMIN. & STUDENT
SUPPORT OFFICES**

**RENOVATED
HEALTH SUITE**

**TYPICAL CLASSROOM POD WITH
NEW DIVISION WALLS AND
DOORS**

PROPOSED FIRST FLOOR PLAN

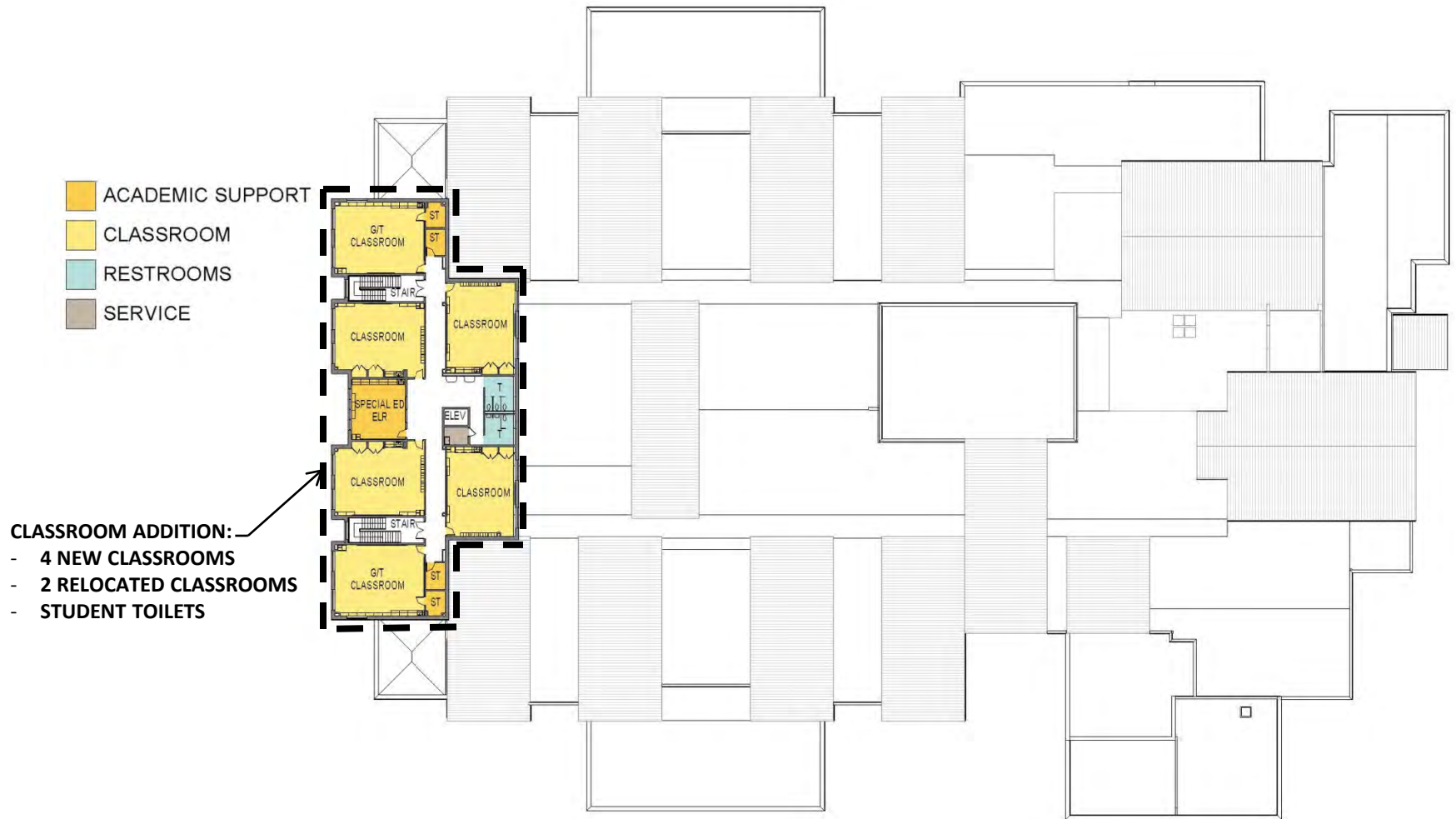

PROPOSED SECOND FLOOR PLAN

Total Project Budget

Base Construction Estimate*	\$16,984,727
<u>(Includes 8% Construction Contingency \$1,358,778)</u>	
Architect/Engineering Fee	\$1,199,000
Construction Management Fee	\$1,240,472
Related Costs	\$762,500
Project Contingency	\$762,500
Equipment	\$50,000
Total Project Estimate	\$20,999,199
Project Budget Total	\$19,816,000
Alternate # 1: Additional parking spaces	\$619,556
Alternate # 2: Addition to M.I.N.C. classrooms	\$267,883

Summary

- Construction document presentation scheduled for February 2014
- Receive bids May 2014
- Construction completed August 2016
- Request approval of report and allow staff to proceed to construction documents phase