

New Elementary School #42

Construction Documents Report

Scott Washington

Director, School Construction

March 24, 2016

Project Update

- Provided paved access path from buss loop to the community walking path at the rear of the building
- Reconfiguration kitchen area to accommodate new equipment and to centralize the kitchen manager office
- Update the building elevations in coordination with the county Design Advisory Panel



Site Plan

New Elementary School #42

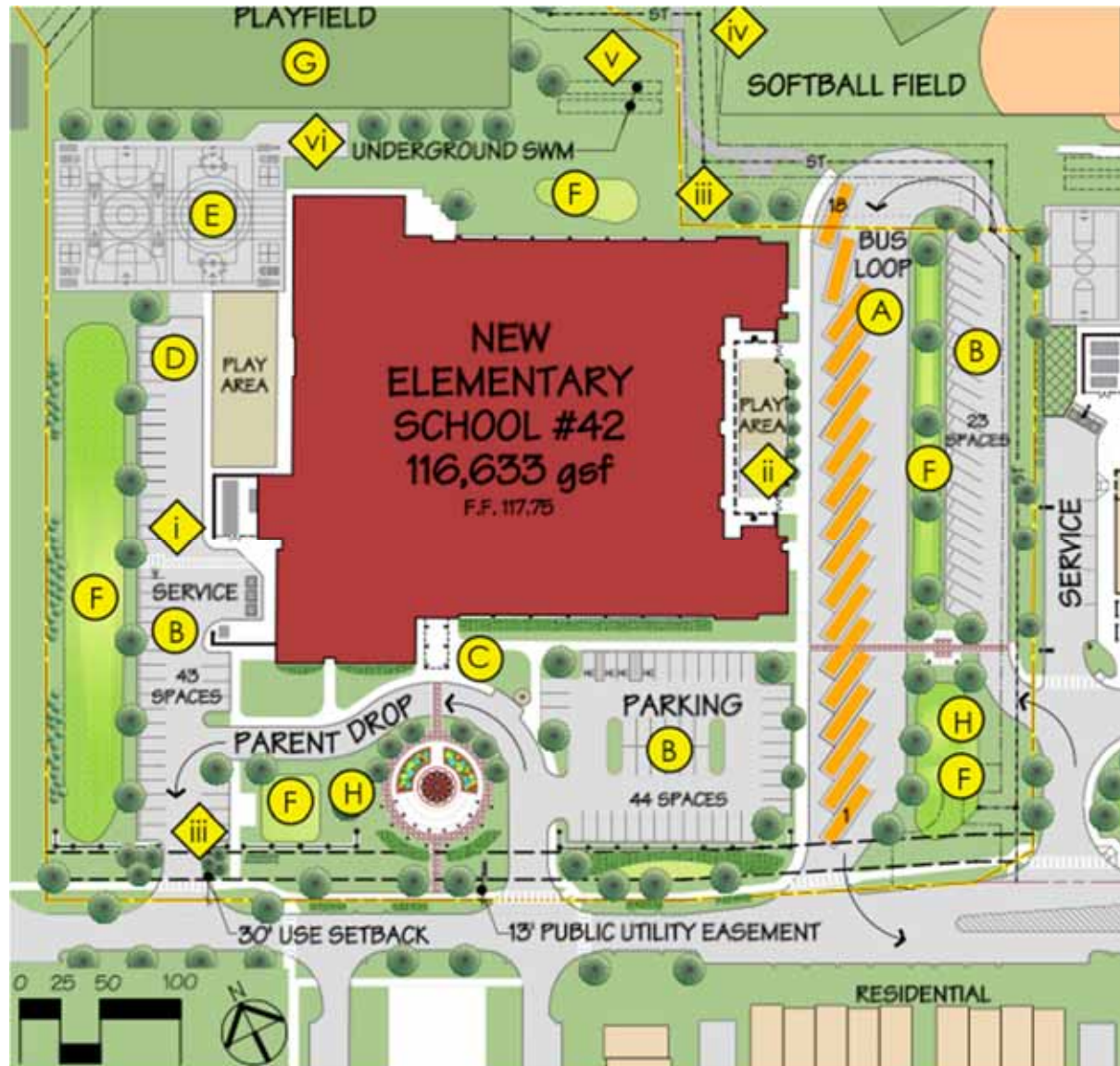

- (A) School bus parking for 18 busses. The bus driveway is separate from the parent drop-off driveway to reduce vehicular congestion on site.
- (B) To provide as much car parking on site as possible, 110 parking spaces have been provided among the three areas on site.
- (C) Parent drop-off and pickup area adjacent to the main entrance with an ample queuing area to eliminate interference with the main parking lot.
- (D) Service drive with emergency vehicle access to the paved play area.
- (E) Paved play area adjacent to gymnasium and cafeteria.
- (F) Storm water management bio-retention facilities in addition to the underground storm water management facility.
- (G) Playfields have been located adjacent to the gymnasium, cafeteria, and locker rooms, such that students will not have to cross vehicular roads or driveways to access.
- (H) Locations of outdoor classroom areas.

Enlarged Site Plan

LEGEND

- Kindergarten / Early Childhood
- Grades 1-5
- Special Education
- Central Support Spaces
- Administrative Spaces
- Building Services
- Rec. and Parks

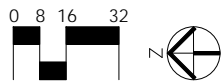
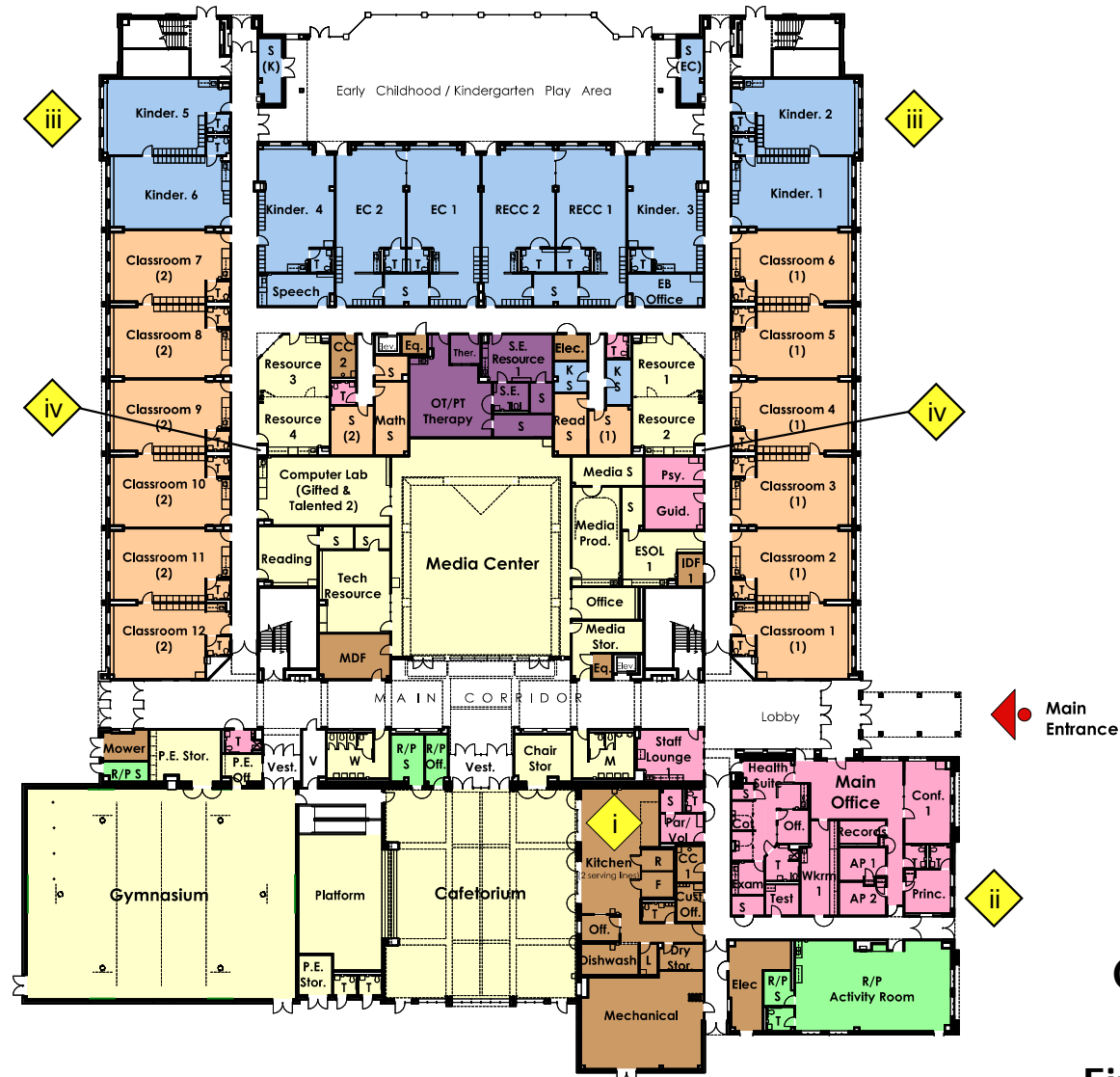

Construction
Document
First Floor Plan

LEGEND

- Kindergarten / Early Childhood
- Grades 1-5
- Special Education
- Central Support Spaces
- Administrative Spaces
- Building Services
- Rec. and Parks

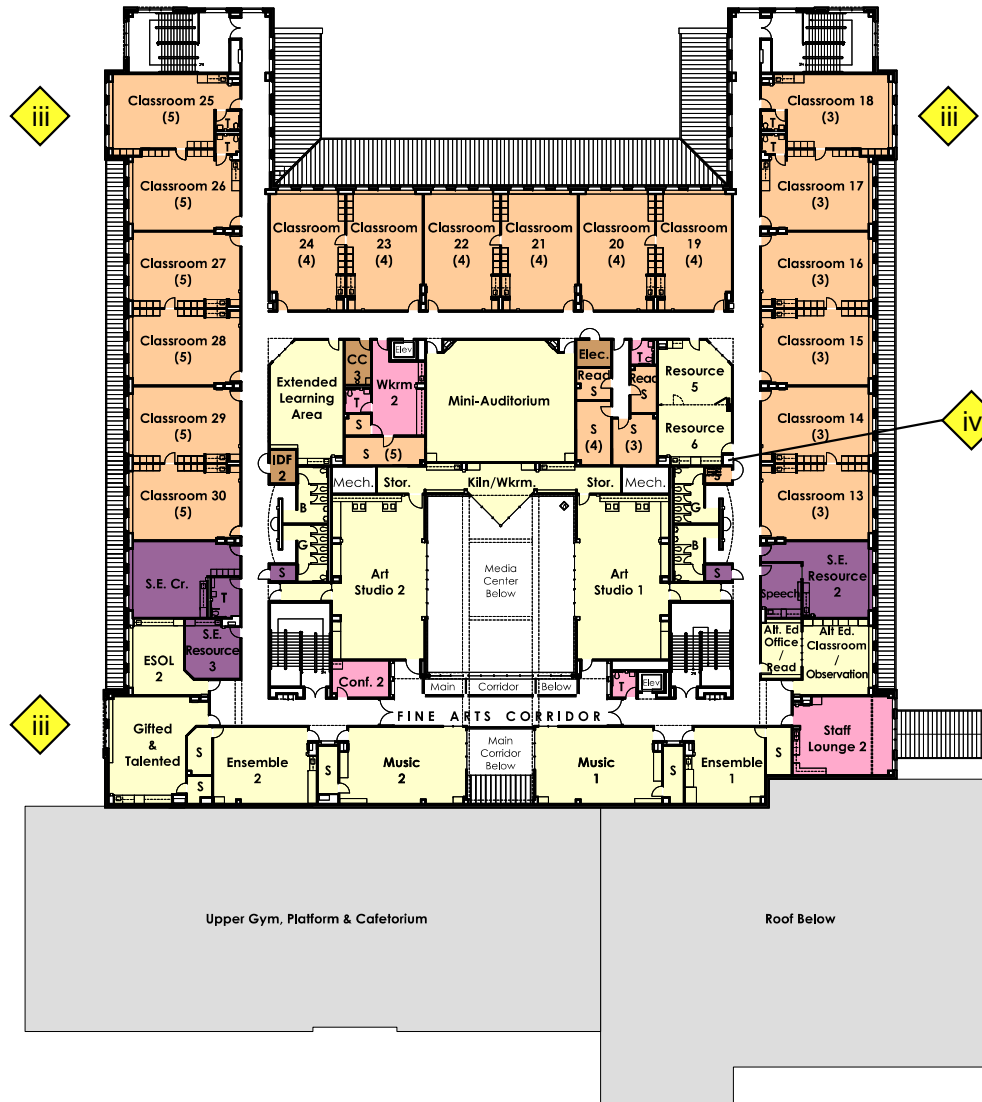

Construction Document Second Floor Plan

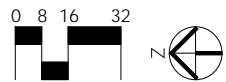



Total Project Budget

| | |
|--|--------------|
| Base Construction Estimate | \$32,994,732 |
| Architect/Engineering Fee | \$2,474,585 |
| Construction Management Fee | \$2,350,000 |
| Related Costs | \$1,666,000 |
| Project Contingency | \$1,666,000 |
| Equipment and Technology | \$2,333,520 |
| Alternate #1: Outdoor Classroom at Main Entrance | \$232,978 |
| Alternate #2: Instructional Gazebo at Bus Loop | \$114,350 |
| Alternate #3: Sod in lieu of Seed | \$46,975 |
| Alternate #4: Neighborhood Storm water tie-in | \$28,373 |
| Project Total Budget | \$43,907,513 |

| | |
|---------------------------|--------------|
| Funding Projections | |
| FY16 | \$2,807,000 |
| FY17 | \$16,526,000 |
| FY18 | \$20,658,000 |
| FY19 | \$4,132,000 |
| Total Funding Projections | \$44,123,000 |

Summary

- Schedule
 - Receive bids June 2016
 - Construction starts September 2016
 - Completion August 2018
- Request approval of construction documents and allow staff to proceed to project bid